

LOCATION

|                  |  |
|------------------|--|
| Property Address | 230 McCubbins Rd<br>Knoxville, TN 37924-4533 |
| Subdivision      |  |
| County           | Knox County, TN                              |

PROPERTY SUMMARY

|                  |               |
|------------------|---------------|
| Property Type    | Residential   |
| Land Use         | 1 Family      |
| Improvement Type | Single Family |
| Square Feet      | 1410          |

GENERAL PARCEL INFORMATION

|                      |         |
|----------------------|---------|
| Parcel ID/Tax ID     | 062 274 |
| Alternate Parcel ID  | 106372  |
| Account Number       |         |
| District/Ward        | COU     |
| 2010 Census Trct/Blk | 53.02/2 |
| Assessor Roll Year   | 2020    |

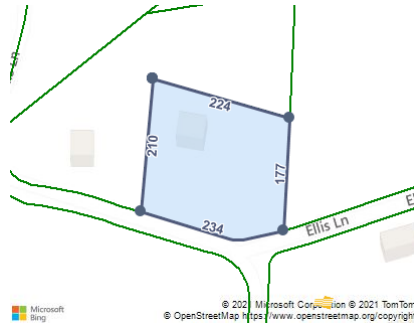

SCHOOL ZONE INFORMATION

|                          |          |
|--------------------------|----------|
| Carter Elementary School | 0.3 mi   |
| Elementary: K to 5       | Distance |
| Carter Middle School     | 1.1 mi   |
| Middle: 6 to 8           | Distance |
| Carter High School       | 1.2 mi   |
| High: 9 to 12            | Distance |

TAX ASSESSMENT

| Appraisal              | Amount   | Assessment            | Amount   | Jurisdiction | Rate |
|------------------------|----------|-----------------------|----------|--------------|------|
| Appraisal Year         | 2020     | Assessment Year       | 2020     |              |      |
| Appraised Land         | \$18,000 | Assessed Land         |          | Knox County  | 2.12 |
| Appraised Improvements | \$70,000 | Assessed Improvements |          |              |      |
| Total Tax Appraisal    | \$88,000 | Total Assessment      | \$22,000 |              |      |
|                        |          | Exempt Amount         |          |              |      |
|                        |          | Exempt Reason         |          |              |      |

TAXES

| Tax Year | City Taxes | County Taxes | Total Taxes |
|----------|------------|--------------|-------------|
| 2019     |            | \$466.00     | \$466.00    |
| 2018     |            | \$466.00     | \$466.00    |
| 2017     |            | \$466.00     | \$466.00    |
| 2016     |            | \$450.00     | \$450.00    |
| 2015     |            | \$450.00     | \$450.00    |
| 2014     |            | \$450.08     | \$450.08    |
| 2013     |            | \$450.08     | \$450.08    |

MORTGAGE HISTORY

No mortgages were found for this parcel.

PROPERTY CHARACTERISTICS: BUILDING

Building # 1

|               |               |                |                |         |   |
|---------------|---------------|----------------|----------------|---------|---|
| Type          | Single Family | Condition      | Normal For Age | Units   |   |
| Year Built    | 1948          | Effective Year | 1975           | Stories | 1 |
| BRs           | 3             | Baths          | 1 F 1 H        | Rooms   | 6 |
| Total Sq. Ft. | 1,410         |                |                |         |   |

Building Square Feet (Living Space)

1.0 Floor Level Finished 1284

Building Square Feet (Other)

Basement Unfinished 1284  
Concrete Patio 126  
First Story (Base) 1284  
Masonry Stoop 70  
Integral Carport 144  
Open Frame Porch 98

- CONSTRUCTION

|                    |               |                   |                  |
|--------------------|---------------|-------------------|------------------|
| Quality            | Average       | Roof Framing      | Gable            |
| Shape              |               | Roof Cover Deck   | Asphalt Shingles |
| Partitions         |               | Cabinet Millwork  |                  |
| Common Wall        |               | Floor Finish      |                  |
| Foundation         | Full Basement | Interior Finish   | Drywall          |
| Floor System       |               | Air Conditioning  | Central Ac       |
| Exterior Wall      | Vinyl Siding  | Heat Type         | Heat Pump        |
| Structural Framing |               | Bathroom Tile     |                  |
| Fireplace          |               | Plumbing Fixtures | 9                |

- OTHER

Occupancy Building Data Source

PROPERTY CHARACTERISTICS: EXTRA FEATURES

| Feature                        | Size or Description | Year Built | Condition            |
|--------------------------------|---------------------|------------|----------------------|
| Residential Small Utility Shed | 168                 | 1990       | POOR FOR AGE         |
| Carport                        | 288                 | 1997       | BELOW NORMAL FOR AGE |

PROPERTY CHARACTERISTICS: LOT

|                    |                        |                 |        |
|--------------------|------------------------|-----------------|--------|
| Land Use           | 1 Family               | Lot Dimensions  |        |
| Block/Lot          |                        | Lot Square Feet | 52,272 |
| Latitude/Longitude | 36.020622°/-83.735824° | Acreage         | 1.2    |

PROPERTY CHARACTERISTICS: UTILITIES/AREA

|                 |  |                         |   |
|-----------------|--|-------------------------|---|
| Gas Source      |  | Road Type               |   |
| Electric Source |  | Topography              |   |
| Water Source    |  | District Trend          |   |
| Sewer Source    |  | Special School District | 1 |

|                   |   |                           |
|-------------------|---|---------------------------|
| Zoning Code       | A | Special School District 2 |
| Owner Type        |   |                           |
| LEGAL DESCRIPTION |   |                           |
| Subdivision       |   | Plat Book/Page            |
| Block/Lot         |   | District/Ward             |
| Description       |   | COU                       |

FEMA FLOOD ZONES

| Zone Code | Flood Risk | BFE | Description  | FIRM Panel ID | FIRM Panel Eff. Date |
|-----------|------------|-----|--|---------------|----------------------|
| X         | Minimal    |     | Area of minimal flood hazard, usually depicted on FIRMs as above the 500-year flood level. | 47093C0188F   | 05/02/2007           |