

LOCATION

Property Address	Moonstone Ln TN
Subdivision	Rock Harbor Phase I
County	Claiborne County, TN

PROPERTY SUMMARY

Property Type	Residential
Land Use	
Improvement Type	
Square Feet	

GENERAL PARCEL INFORMATION

Parcel ID/Tax ID	124B A 189.00 000
Special Int	000
Alternate Parcel ID	
Land Map	124G
District/Ward	03
2010 Census Trct/Bik	9706/3
Assessor Roll Year	2020

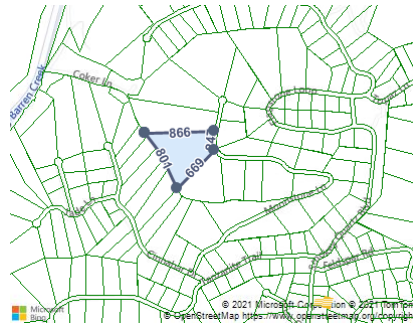

CURRENT OWNER

Name	Farm Credit Mid-America Fica Attn Sau
Mailing Address	716 Callahan Dr Knoxville, TN 37912-1301

SCHOOL INFORMATION

These are the closest schools to the property

Midway Elementary School	4.2 mi
Primary Middle: Pre K to 8	Distance
Claiborne High School	8.0 mi
High: 9 to 12	Distance

SALES HISTORY THROUGH 04/06/2021

Date	Amount	Buyer/Owners	Seller	Instrument	No. Parcels	Book/Page Or Document#
10/19/2018		Farm Credit Mid-America Fica Attn Sau	Evans William S Jr & Lynn	Trustees Deed		1507/517
8/27/2014	\$56,500	Evans William S Jr & Lynn		Warranty Deed		1425/164
10/26/2007	\$80,910	Helton Greg		Warranty Deed		1252/326
9/26/2006	\$89,900	Niles Bruce A & Jacqueline A		Warranty Deed		1216/374
6/24/2005		Waterfront Group Inc 17505 W Catawba Avenue			266	1181/810

TAX ASSESSMENT

Appraisal	Amount	Assessment	Amount	Jurisdiction	Rate
Appraisal Year	2020	Assessment Year	2020		
Appraised Land	\$16,400	Assessed Land		Claiborne	2.5777
Appraised Improvements		Assessed Improvements			
Total Tax Appraisal	\$16,400	Total Assessment	\$4,100		
		Exempt Amount			
		Exempt Reason			

TAXES

Tax Year	City Taxes	County Taxes	Total Taxes
2020		\$105.69	\$105.69
2019		\$105.69	\$105.69
2018		\$105.69	\$105.69
2017		\$105.69	\$105.69
2016		\$364.43	\$364.43
2015		\$350.30	\$350.30
2014		\$350.30	\$350.30
2013		\$350.30	\$350.30

MORTGAGE HISTORY

Date	Loan Amount	Borrower	Lender	Book/Page or Document#
09/08/2014	\$106,250	Evans William S Jr Evans Lynn	Farm Credit Services	1425/167 15000675
11/04/2007	\$84,000	Helton Greg	First Century Bank	1252/329 07019149
09/30/2006	\$80,910	Niles Bruce A Niles Jacqueline A	First Century Bank	1216/377

PROPERTY CHARACTERISTICS: BUILDING

No Buildings were found for this parcel.

PROPERTY CHARACTERISTICS: EXTRA FEATURES

No extra features were found for this parcel.

PROPERTY CHARACTERISTICS: LOT

Land Use	Lot Dimensions
Block/Lot	Lot Square Feet
/189	330,619
Latitude/Longitude	Acreage
36.381568°/-83.703663°	7.59

PROPERTY CHARACTERISTICS: UTILITIES/AREA

Gas Source	Road Type
Electric Source	Paved
Public	Topography
Water Source	Rolling
Public	District Trend
Sewer Source	Improving
Individual	Special School District 1
Zoning Code	Special School District 2
Owner Type	

LEGAL DESCRIPTION

Subdivision	Plat Book/Page
Rock Harbor Phase I	4/109
Block/Lot	District/Ward
/189	03
Description	

FEMA FLOOD ZONES

Zone Code	Flood Risk	BFE	Description	FIRM Panel ID	FIRM Panel Eff. Date
X	Minimal		Area of minimal flood hazard, usually depicted on FIRMs as above the 500-year flood level.	47025C0225E	11/02/2011