

**LOCATION**

**Property Address** 12001 Old Jackson Ridge Rd  
Rockvale, TN

**Subdivision**

**County** Rutherford County, TN

**PROPERTY SUMMARY**

**Property Type** Commercial

**Land Use** Commercial

**Improvement Type** Convenience Store

**Square Feet** 1984

**GENERAL PARCEL INFORMATION**

**Parcel ID/Tax ID** 139 058.02

**Alternate Parcel ID** 139 05802 00010139

**Account Number** R0079907

**District/Ward** 5

**2010 Census Trct/Blk** 408.09/1

**Assessor Roll Year** 2020

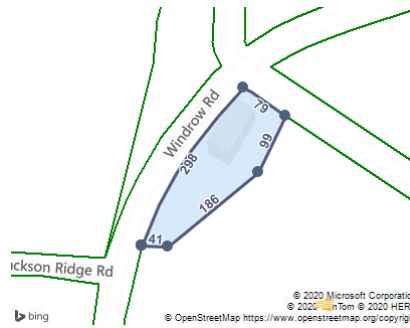

**CURRENT OWNER**

**Name** Bugbee Barry D/B/A Bo Jacks Market

**Mailing Address** 1306 Tellico Ave  
Murfreesboro, TN 37129-4502

**SALES HISTORY THROUGH 10/12/2020**

Date	Amount	Buyer/Owners	Seller	Instrument	No. Parcels	Book/Page Or Document#
1/16/2019	\$229,000	Bugbee Barry D/B/A Jacks Market	Lewis Michael	Accepted And Qualified		1742/2244
7/8/2011	\$63,100	Lewis Michael	Patel Suman B Etal Natvar T Patel	Trustee's Deed		1070/3796
11/5/1997	\$120,000	Patel Suman B Etal Natvar T Patel		Personal Property		610/455
12/27/1995	\$70,000	McMahan Betty Etal Brandy McCormick		Accepted And Qualified		563/703
10/25/1993	\$51,000	Leathers Jesse Etux Ruthan		Physical Difference		513/40
1/27/1993	\$40,000	Henkel Karen L Etux Ruthan		Family Sale		496/555
11/24/1987		Patient Terry J Etux Ruthan				395/484
8/6/1984		Vaughn James Etux Joyce %Bo Jacks Market				336/314

**TAX ASSESSMENT**

Appraisal	Amount	Assessment	Amount	Jurisdiction	Rate
<b>Appraisal Year</b>	2020	<b>Assessment Year</b>	2020		
<b>Appraised Land</b>	\$22,700	<b>Assessed Land</b>	\$9,080	<b>Rutherford</b>	2.2194
<b>Appraised Improvements</b>	\$50,200	<b>Assessed Improvements</b>	\$20,080		
<b>Total Tax Appraisal</b>	\$72,900	<b>Total Assessment</b>	\$29,160		
		<b>Exempt Amount</b>			
		<b>Exempt Reason</b>			

**TAXES**

Tax Year	City Taxes	County Taxes	Total Taxes
2019		\$647.18	\$647.18
2018		\$612.19	\$612.19
2017		\$609.97	\$609.97
2016		\$609.97	\$609.97
2014		\$565.97	\$565.97
2013		\$769.56	\$769.56

**PROPERTY CHARACTERISTICS: BUILDING**

**Building # 1**

Type	Convenience Store	Condition	Average	Units	1
<b>Year Built</b>	1973	<b>Effective Year</b>	1983	<b>Stories</b>	1
<b>BRs</b>		<b>Baths</b>	F H	<b>Rooms</b>	

Total Sq. Ft.	1,984 <th>Building Square Feet (Living Space)</th> <th>Building Square Feet (Other)</th>	Building Square Feet (Living Space)	Building Square Feet (Other)
Base 1984			

**- CONSTRUCTION**

Quality	Low	Roof Framing	Shed
<b>Shape</b>		<b>Roof Cover Deck</b>	
<b>Partitions</b>		<b>Cabinet Millwork</b>	
<b>Common Wall</b>		<b>Floor Finish</b>	
<b>Foundation</b>		<b>Interior Finish</b>	
<b>Floor System</b>		<b>Air Conditioning</b>	
<b>Exterior Wall</b>		<b>Heat Type</b>	Package Unit
<b>Structural Framing</b>	Masonry	<b>Bathroom Tile</b>	
<b>Fireplace</b>		<b>Plumbing Fixtures</b>	2

**- OTHER**

Occupancy	Building Data Source

**PROPERTY CHARACTERISTICS: EXTRA FEATURES**

Feature	Size or Description	Year Built	Condition
Asph Pav	1600		AVERAGE

**PROPERTY CHARACTERISTICS: LOT**

Land Use	Commercial	Lot Dimensions	307 X 75 IRR
<b>Block/Lot</b>		<b>Lot Square Feet</b>	22,651
<b>Latitude/Longitude</b>	35.758374/-86.556060°	<b>Acreage</b>	0.52

**PROPERTY CHARACTERISTICS: UTILITIES/AREA**

Gas Source	None	Road Type	Paved
<b>Electric Source</b>	Public	<b>Topography</b>	Level
<b>Water Source</b>	Individual	<b>District Trend</b>	Static
<b>Sewer Source</b>	None	<b>Special School District 1</b>	
<b>Zoning Code</b>		<b>Special School District 2</b>	

<b>Owner Type</b>	Private
<b>LEGAL DESCRIPTION</b>	
<b>Subdivision</b>	<b>Plat Book/Page</b>
<b>Block/Lot</b>	<b>District/Ward</b>
<b>Description</b>	5
307X75 Irr	

FEMA FLOOD ZONES

<b>Zone Code</b>	<b>Flood Risk</b>	<b>BFE</b>	<b>Description</b>	<b>FIRM Panel ID</b>	<b>FIRM Panel Eff. Date</b>
X	Minimal		Area of minimal flood hazard, usually depicted on FIRMs as above the 500-year flood level.	47149C0245H	01/05/2007