

LOCATION

Property Address 6920 Harvest Grove Ln
Knoxville, TN 37918-1028

Subdivision Harvest Grove S/D

County Knox County, TN



PROPERTY SUMMARY

Property Type Open Space

Land Use Unused Land

Improvement Type

Square Feet

GENERAL PARCEL INFORMATION

Parcel ID/Tax ID 057FH022

Alternate Parcel ID 194970

Account Number

District/Ward COU

2010 Census Trct/Blk 62.07/1

Assessor Roll Year 2019

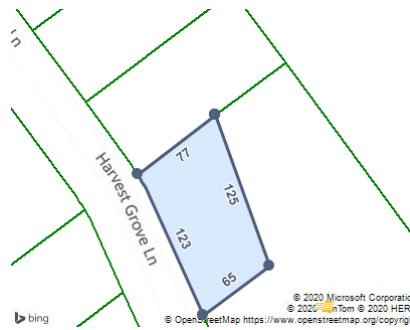

CURRENT OWNER

Name Tnbank Of Oak Ridge

Mailing Address 401 S Illinois Ave
Oak Ridge, TN 37830-7510

TAX ASSESSMENT

Appraisal	Amount	Assessment	Amount	Jurisdiction	Rate
Appraisal Year	2019	Assessment Year	2019	Knox County	2.12
Appraised Land	\$22,000	Assessed Land			
Appraised Improvements		Assessed Improvements			
Total Tax Appraisal	\$22,000	Total Assessment	\$5,500		
		Exempt Amount			
		Exempt Reason			

TAXES

Tax Year	City Taxes	County Taxes	Total Taxes
2019		\$117.00	\$117.00
2018		\$117.00	\$117.00
2017		\$117.00	\$117.00
2016		\$128.00	\$128.00
2015		\$128.00	\$128.00
2014		\$127.60	\$127.60
2013		\$127.60	\$127.60

MORTGAGE HISTORY

No mortgages were found for this parcel.

PROPERTY CHARACTERISTICS: BUILDING

No Buildings were found for this parcel.

PROPERTY CHARACTERISTICS: EXTRA FEATURES

No extra features were found for this parcel.

PROPERTY CHARACTERISTICS: LOT

Land Use	Unused Land	Lot Dimensions	122.5 X 76.17 X IRR
Block/Lot	/22	Lot Square Feet	8,466
Latitude/Longitude	36.038201°/-83.984588°	Acreage	

PROPERTY CHARACTERISTICS: UTILITIES/AREA

Gas Source	Gas	Road Type	
Electric Source		Topography	
Water Source	Water	District Trend	
Sewer Source	Sewer	Special School District 1	
Zoning Code		Special School District 2	
Owner Type			

LEGAL DESCRIPTION

Subdivision	Harvest Grove S/D	Plat Book/Page	20071015/31572
Block/Lot	/22	District/Ward	COU
Description	Subdivisionname Harvest Grove S/D Mapplatb 20071015 Mapplatp 0031572 Dimensions 122.5 X 76.17 X Irr		

FEMA FLOOD ZONES

Zone Code	Flood Risk	BFE	Description	FIRM Panel ID	FIRM Panel Eff. Date
X	Minimal		Area of minimal flood hazard, usually depicted on FIRMs as above the 500-year flood level.	47093C0136F	05/02/2007