

**LOCATION**

<b>Property Address</b>	341 Boiling Springs Rd Vonore, TN 37885
<b>Subdivision</b>	Boiling Springs Shores
<b>County</b>	Monroe County, TN

**PROPERTY SUMMARY**

<b>Property Type</b>	Farm
<b>Land Use</b>	Single Family
<b>Improvement Type</b>	Single Family
<b>Square Feet</b>	384

**GENERAL PARCEL INFORMATION**

<b>Parcel ID/Tax ID</b>	071 005.01
<b>Special Int</b>	000
<b>Alternate Parcel ID</b>	
<b>Land Map</b>	071
<b>District/Ward</b>	04
<b>2010 Census Trct/Bik</b>	9250/1
<b>Assessor Roll Year</b>	2019

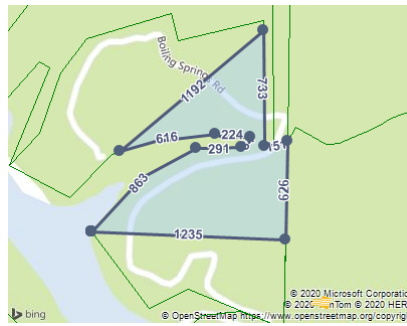

**CURRENT OWNER**

<b>Name</b>	Tn Bank Of Oak Ridge
<b>Mailing Address</b>	401 S Illinois Ave Oak Ridge, TN 37830-7510

**SALES HISTORY THROUGH 08/18/2020**

Date	Amount	Buyer/Owners	Seller	Instrument	No. Parcels	Book/Page Or Document#
7/13/2010		Tn Bank Of Oak Ridge			3	342/741
2/28/2006	\$363,260	Hicks Charles B Tn Bank		Warranty Deed	3	310/103
11/9/2005	\$90,000	Woody Charles M & William K Ledford		Warranty Deed	4	307/243
9/28/2004	\$300,000	Woody Michael L Etux Linda J		Warranty Deed	3	296/457

**TAX ASSESSMENT**

Appraisal	Amount	Assessment	Amount	Jurisdiction	Rate
<b>Appraisal Year</b>	2019	<b>Assessment Year</b>	2019	<b>Monroe</b>	1.9796
<b>Appraised Land</b>	\$79,600	<b>Assessed Land</b>			
<b>Appraised Improvements</b>	\$26,200	<b>Assessed Improvements</b>			
<b>Total Tax Appraisal</b>	\$105,800	<b>Total Assessment</b>	\$26,450		
		<b>Exempt Amount</b>			
		<b>Exempt Reason</b>			

**TAXES**

Tax Year	City Taxes	County Taxes	Total Taxes
2019		\$523.60	\$523.60
2018		\$523.60	\$523.60
2017		\$553.92	\$553.92
2016		\$519.36	\$519.36
2015		\$519.36	\$519.36
2014		\$519.36	\$519.36
2013		\$519.36	\$519.36

**PROPERTY CHARACTERISTICS: BUILDING**

<b>Building # 1</b>			
<b>Type</b>	Single Family	<b>Condition</b>	Average
<b>Year Built</b>	2005	<b>Effective Year</b>	2006
<b>BRs</b>		<b>Baths</b>	F H
<b>Total Sq. Ft.</b>	384	<b>Units</b>	1
<b>Building Square Feet (Living Space)</b>		<b>Rooms</b>	
Base 384		<b>Building Square Feet (Other)</b>	
<b>- CONSTRUCTION</b>			
<b>Quality</b>	Average	<b>Roof Framing</b>	Gable/Hip
<b>Shape</b>	Rectangular Design	<b>Roof Cover Deck</b>	Prefin Metal Crimped
<b>Partitions</b>		<b>Cabinet Millwork</b>	Average
<b>Common Wall</b>		<b>Floor Finish</b>	Carpet Combination
<b>Foundation</b>	Continuous Footing	<b>Interior Finish</b>	Drywall
<b>Floor System</b>	Wood W/ Sub Floor	<b>Air Conditioning</b>	Cooling Split
<b>Exterior Wall</b>	Siding Above Avg	<b>Heat Type</b>	Heat Split
<b>Structural Framing</b>		<b>Bathroom Tile</b>	Floor Only
<b>Fireplace</b>		<b>Plumbing Fixtures</b>	1
<b>- OTHER</b>			
<b>Occupancy</b>	Occupied	<b>Building Data Source</b>	Inspection

**PROPERTY CHARACTERISTICS: EXTRA FEATURES**

No extra features were found for this parcel.

**PROPERTY CHARACTERISTICS: LOT**

<b>Land Use</b>	Single Family	<b>Lot Dimensions</b>	
<b>Block/Lot</b>		<b>Lot Square Feet</b>	875,117
<b>Latitude/Longitude</b>	35.500165°/-84.205138°	<b>Acreage</b>	20.09
<b>Type</b>	<b>Land Use</b>	<b>Units</b>	<b>Tax Assessor Value</b>
Imp Site		0.5 Ac	\$4,360
Rotation		19.59 Ac	\$75,230

**PROPERTY CHARACTERISTICS: UTILITIES/AREA**

<b>Gas Source</b>		<b>Road Type</b>	Gravel
<b>Electric Source</b>	Public	<b>Topography</b>	Rolling
<b>Water Source</b>	Individual	<b>District Trend</b>	Stable
<b>Sewer Source</b>	Individual	<b>Special School District 1</b>	
<b>Zoning Code</b>		<b>Special School District 2</b>	

Owner Type

LEGAL DESCRIPTION

Subdivision	Boiling Springs Shores	Plat Book/Page	F/32
Block/Lot		District/Ward	04
Description	Tract 2		

FEMA FLOOD ZONES

Zone Code	Flood Risk	BFE	Description	FIRM Panel ID	FIRM Panel Eff. Date
X	Minimal		Area of minimal flood hazard, usually depicted on FIRMs as above the 500-year flood level.	47123C0305D	02/03/2010
X	Minimal		Area of minimal flood hazard, usually depicted on FIRMs as above the 500-year flood level.	47123C0190D	02/03/2010
A	High		Areas subject to inundation by the 1-percent-annual-chance flood event generally determined using approximate methodologies. Because detailed hydraulic analyses have not been performed, no Base Flood Elevations (BFEs) or flood depths are shown. Mandatory flood insurance purchase requirements and floodplain management standards apply.	47123C0305D	02/03/2010