

LOCATION

Property Address 2124 Duncan Rd
Maryville, TN 37803-3446

Subdivision

County Blount County, TN

PROPERTY SUMMARY

Property Type Residential

Land Use Household Units

Improvement Type Single Family

Square Feet 1613

GENERAL PARCEL INFORMATION

Parcel ID/Tax ID 069 074.00

Special Int 000

Alternate Parcel ID

Land Map 069

District/Ward 09

2010 Census Trct/Blk 111.01/3

Assessor Roll Year 2019

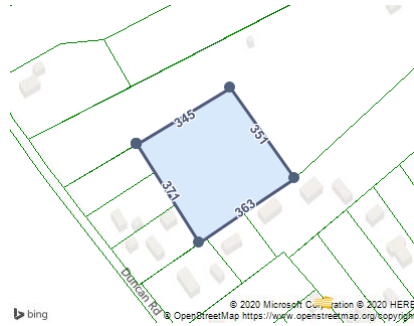

CURRENT OWNER

Name Vickers Okhui C

Mailing Address 2124 Duncan Rd
Maryville, TN 37803-3446

SALES HISTORY THROUGH 07/10/2020

Date	Amount	Buyer/Owners	Seller	Instrument	No. Parcels	Book/Page Or Document#
2/3/2011		Vickers Okhui C			4	WB86/247
11/21/1991	\$118,500	Vickers Stephen N & Okhui C		Warranty Deed	3	532/877
8/1/1988	\$70,000	Russell Terry M & Linda F		Warranty Deed		498/690
6/1/1957		Roberts Minnis A & Virginia Ruth				206/347

TAX ASSESSMENT

Appraisal	Amount	Assessment	Amount	Jurisdiction	Rate
Appraisal Year	2019	Assessment Year	2019	Blount	2.47
Appraised Land	\$66,300	Assessed Land			
Appraised Improvements	\$125,200	Assessed Improvements			
Total Tax Appraisal	\$191,500	Total Assessment	\$47,875		
		Exempt Amount			
		Exempt Reason			

TAXES

Tax Year	City Taxes	County Taxes	Total Taxes
2019		\$1,182.51	\$1,182.51
2018		\$1,109.65	\$1,109.65
2017		\$1,109.65	\$1,109.65
2016		\$1,109.65	\$1,109.65
2015		\$1,109.65	\$1,109.65
2014		\$965.89	\$965.89

MORTGAGE HISTORY

Date	Loan Amount	Borrower	Lender	Book/Page or Document#
05/13/2010	\$100,000	Vickers Stephen N Ok Hui	Y12 Federal Credit Union	2264/76
06/22/2005	\$126,816	Vickers Stephen M Vickers Okhui	First Horizon	2063/1601
09/08/1998	\$73,587	Vickers Stephen	Vickers Paul	814/349

PROPERTY CHARACTERISTICS: BUILDING

Building # 1		Condition	Average	Units
Type	Single Family	Effective Year	1991	Stories 1
Year Built	1957	Baths	F H	Rooms
Total Sq. Ft. 1,613		Building Square Feet (Other)		
Building Square Feet (Living Space) Base 1613		Basement Finished 1176		
		Enclosed Porch Finished 99		
		Garage Unfinished 484		
		Open Porch Unfinished 72		

- CONSTRUCTION

Quality	Average	Roof Framing	Gable/Hip
Shape	Rectangular Design	Roof Cover Deck	Prefin Metal Crimped
Partitions		Cabinet Millwork	Average
Common Wall		Floor Finish	Carpet Combination
Foundation	Continuous Footing	Interior Finish	Panel-Plast-Drywall
Floor System	Wood W/ Sub Floor	Air Conditioning	Cooling Split
Exterior Wall	Brick/Wood	Heat Type	Heat Split
Structural Framing		Bathroom Tile	
Fireplace		Plumbing Fixtures	4
- OTHER		Building Data Source	Owner
Occupancy	Occupied		

PROPERTY CHARACTERISTICS: EXTRA FEATURES

Feature	Size or Description	Year Built	Condition
Wood Deck	114	2011	FAIR
Wood Deck	230	2011	FAIR
Stoop	28	1982	EXCELLENT

PROPERTY CHARACTERISTICS: LOT

Land Use	Household Units	Lot Dimensions

Block/Lot		Lot Square Feet	128,501
Latitude/Longitude	35.730350°/-83.946657°	Acreage	2.95

PROPERTY CHARACTERISTICS: UTILITIES/AREA

Gas Source		Road Type	Private/None
Electric Source	Public	Topography	Rolling
Water Source	Public	District Trend	
Sewer Source	Individual	Special School District 1	
Zoning Code	S	Special School District 2	
Owner Type			

LEGAL DESCRIPTION

Subdivision		Plat Book/Page	
Block/Lot		District/Ward	09
Description			

FEMA FLOOD ZONES

Zone Code	Flood Risk	BFE	Description	FIRM Panel ID	FIRM Panel Eff. Date
X	Minimal		Area of minimal flood hazard, usually depicted on FIRMs as above the 500-year flood level.	47009C0252C	09/19/2007