

LOCATION

Property Address	E Of Mooneyham Rd TN
Subdivision	
County	Van Buren County, TN
PROPERTY SUMMARY	
Property Type	Residential
Land Use	Household Units
Improvement Type	
Square Feet	
GENERAL PARCEL INFORMATION	
Parcel ID/Tax ID	033 006.03
Special Int	000
Alternate Parcel ID	
Land Map	033
District/Ward	03
2010 Census Trct/Blk	9250/2
Assessor Roll Year	2019

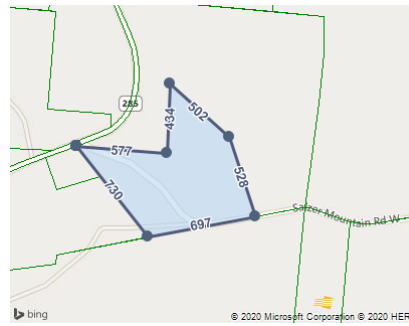

CURRENT OWNER

Name	Howard Dean Et Al
Mailing Address	190 Yosemite Dr Lenoir City, TN 37771-8291

TAX ASSESSMENT

Appraisal	Amount	Assessment	Amount	Jurisdiction	Rate
Appraisal Year	2019	Assessment Year	2019		
Appraised Land	\$31,600	Assessed Land		Van Buren	2.31
Appraised Improvements		Assessed Improvements			
Total Tax Appraisal	\$31,600	Total Assessment	\$7,900		
		Exempt Amount			
		Exempt Reason			

TAXES

Tax Year	City Taxes	County Taxes	Total Taxes
2019		\$182.49	\$182.49
2018		\$152.46	\$152.46
2017		\$152.46	\$152.46
2016		\$152.46	\$152.46
2015		\$152.46	\$152.46
2014		\$144.60	\$144.60
2013		\$144.60	\$144.60

MORTGAGE HISTORY

No mortgages were found for this parcel.

PROPERTY CHARACTERISTICS: BUILDING

No Buildings were found for this parcel.

PROPERTY CHARACTERISTICS: EXTRA FEATURES

No extra features were found for this parcel.

PROPERTY CHARACTERISTICS: LOT

Land Use	Household Units	Lot Dimensions	
Block/Lot		Lot Square Feet	579,346
Latitude/Longitude	35.744552°/-85.329549°	Acreage	13.3

PROPERTY CHARACTERISTICS: UTILITIES/AREA

Gas Source		Road Type	Paved
Electric Source	Public	Topography	Rolling
Water Source		District Trend	Stable
Sewer Source		Special School District 1	
Zoning Code		Special School District 2	
Owner Type			

LEGAL DESCRIPTION

Subdivision		Plat Book/Page	
Block/Lot		District/Ward	03
Description			

FEMA FLOOD ZONES

Zone Code	Flood Risk	BFE	Description	FIRM Panel ID	FIRM Panel Eff. Date
X	Minimal		Area of minimal flood hazard, usually depicted on FIRMs as above the 500-year flood level.	47175C0150C	04/19/2010