

LOCATION

Property Address 707 County Rd  
TN

Subdivision

County McMinn County, TN

PROPERTY SUMMARY

Property Type Farm

Land Use Household Units

Improvement Type

Square Feet

GENERAL PARCEL INFORMATION

Parcel ID/Tax ID 074 095.00

Special Int 000

Alternate Parcel ID

Land Map 074

District/Ward 05

2010 Census Trct/Blk 9708/2

Assessor Roll Year 2019

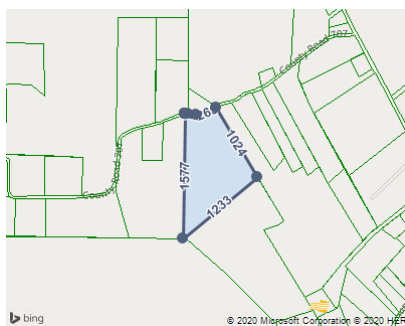

CURRENT OWNER

Name Axley Jerry A Betty Jo

Mailing Address 235 County Road 707  
Athens, TN 37303-6037

TAX ASSESSMENT

Appraisal	Amount	Assessment	Amount	Jurisdiction	Rate
Appraisal Year	2019	Assessment Year	2019		
Appraised Land	\$78,100	Assessed Land		McMinn	1.5469
Appraised Improvements		Assessed Improvements			
Total Tax Appraisal	\$78,100	Total Assessment	\$19,525		
		Exempt Amount			
		Exempt Reason			

TAXES

Tax Year	City Taxes	County Taxes	Total Taxes
2019		\$302.03	\$302.03
2018		\$302.03	\$302.03
2017		\$315.43	\$315.43
2016		\$384.89	\$384.89
2015		\$384.89	\$384.89
2014		\$384.89	\$384.89
2013		\$384.89	\$384.89

PROPERTY CHARACTERISTICS: BUILDING

No Buildings were found for this parcel.

PROPERTY CHARACTERISTICS: EXTRA FEATURES

No extra features were found for this parcel.

PROPERTY CHARACTERISTICS: LOT

Land Use	Household Units	Lot Dimensions	
Block/Lot		Lot Square Feet	922,162
Latitude/Longitude	35.404639°/-84.646263°	Acreage	21.17

PROPERTY CHARACTERISTICS: UTILITIES/AREA

Gas Source		Road Type	Paved
Electric Source	Public	Topography	Level
Water Source	Individual	District Trend	Stable
Sewer Source	Individual	Special School District 1	
Zoning Code		Special School District 2	
Owner Type			

LEGAL DESCRIPTION

Subdivision		Plat Book/Page	
Block/Lot		District/Ward	05
Description	05 071 071 11800 000 05 071 071 11800 000		

FEMA FLOOD ZONES

Zone Code	Flood Risk	BFE	Description	FIRM Panel ID	FIRM Panel Eff. Date
X	Minimal		Area of minimal flood hazard, usually depicted on FIRMs as above the 500-year flood level.	47107C0200D	09/28/2007
X	Minimal		Area of minimal flood hazard, usually depicted on FIRMs as above the 500-year flood level.	47107C0192D	09/28/2007