

LOCATION

**Property Address** 3929 Hillside Terrace Ln  
Knoxville, TN 37924-1061 

**Subdivision** Chestnut Ridge S/D Unit 1

**County** Knox County, TN

PROPERTY SUMMARY

**Property Type** Open Space

**Land Use** Unused Land

**Improvement Type**

**Square Feet**

GENERAL PARCEL INFORMATION

**Parcel ID/Tax ID** 041PA023

**Alternate Parcel ID** 176310

**Account Number**

**District/Ward** COU

**2010 Census Tract/Blk** 52.01/1

**Assessor Roll Year** 2018

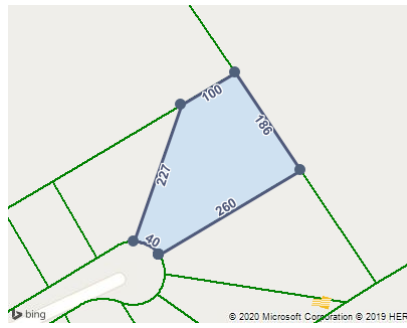

CURRENT OWNER

**Name** Regency Holdings LLC

**Mailing Address** 1175 High Grove Gardens Rd  
Knoxville, TN 37922

SALES HISTORY THROUGH 01/27/2020

Date	Amount	Buyer/Owners	Seller	Instrument	No. Parcels	Book/Page Or Document#
4/15/2005		Regency Holdings LLC	Bunch & Frazier Prop	Warranty Deed	46	200505100089859

TAX ASSESSMENT

Appraisal	Amount	Assessment	Amount	Jurisdiction	Rate
<b>Appraisal Year</b>	2019	<b>Assessment Year</b>	2019	Knox County	2.12
<b>Appraised Land</b>	\$20,000	<b>Assessed Land</b>			
<b>Appraised Improvements</b>		<b>Assessed Improvements</b>			
<b>Total Tax Appraisal</b>	\$20,000	<b>Total Assessment</b>	\$5,000		
		<b>Exempt Amount</b>			
		<b>Exempt Reason</b>			

TAXES

Tax Year	City Taxes	County Taxes	Total Taxes
2019		\$106.00	\$106.00
2018		\$106.00	\$106.00
2017		\$106.00	\$106.00
2016		\$145.00	\$145.00
2015		\$145.00	\$145.00
2014		\$145.00	\$145.00
2013		\$145.00	\$145.00

MORTGAGE HISTORY

No mortgages were found for this parcel.

PROPERTY CHARACTERISTICS: BUILDING

No Buildings were found for this parcel.

PROPERTY CHARACTERISTICS: EXTRA FEATURES

No extra features were found for this parcel.

PROPERTY CHARACTERISTICS: LOT

<b>Land Use</b>	Unused Land	<b>Lot Dimensions</b>	46.39 X 259.9 X IRR
<b>Block/Lot</b>	/23	<b>Lot Square Feet</b>	38,155
<b>Latitude/Longitude</b>	36.070419°/-83.813938°	<b>Acreage</b>	

PROPERTY CHARACTERISTICS: UTILITIES/AREA

<b>Gas Source</b>	Gas	<b>Road Type</b>	
<b>Electric Source</b>		<b>Topography</b>	
<b>Water Source</b>		<b>District Trend</b>	
<b>Sewer Source</b>	Sewer	<b>Special School District 1</b>	
<b>Zoning Code</b>		<b>Special School District 2</b>	
<b>Owner Type</b>			

LEGAL DESCRIPTION

<b>Subdivision</b>	Chestnut Ridge S/D Unit 1	<b>Plat Book/Page</b>	20020529/97929
<b>Block/Lot</b>	/23	<b>District/Ward</b>	COU
<b>Description</b>	Subdivisionname Chestnut Ridge S/D Unit 1 Mapplatb 20020529 Mapplatp 0097929 Dimensions 46.39 X 259.9 X Irr		

FEMA FLOOD ZONES

Zone Code	Flood Risk	BFE	Description	FIRM Panel ID	FIRM Panel Eff. Date
X	Minimal		Area of minimal flood hazard, usually depicted on FIRMs as above the 500-year flood level.	47093C0154F	05/02/2007