

LOCATION

Property Address 3924 Hillside Terrace Ln
Knoxville, TN 37924-1060
Subdivision Chestnut Ridge S/D Unit 1
County Knox County, TN

PROPERTY SUMMARY

Property Type Open Space
Land Use Unused Land
Improvement Type
Square Feet

GENERAL PARCEL INFORMATION

Parcel ID/Tax ID 041PA026
Alternate Parcel ID 176313
Account Number
District/Ward COU
2010 Census Trct/Blk 52.01/1
Assessor Roll Year 2018

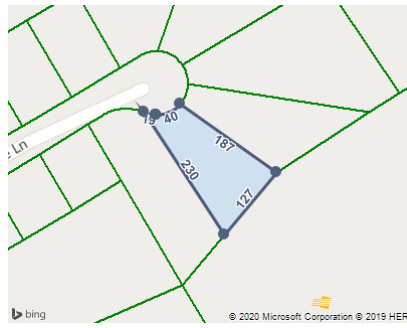

CURRENT OWNER

Name Regency Holdings LLC
Mailing Address 1175 High Grove Gardens Rd
Knoxville, TN 37922

SALES HISTORY THROUGH 01/27/2020

| Date | Amount | Buyer/Owners | Seller | Instrument | No. Parcels | Book/Page Or Document# |
|-----------|--------|----------------------|----------------------|---------------|-------------|------------------------|
| 4/15/2005 | | Regency Holdings LLC | Bunch & Frazier Prop | Warranty Deed | 46 | 200505100089859 |

TAX ASSESSMENT

| Appraisal | Amount | Assessment | Amount | Jurisdiction | Rate |
|------------------------|----------|-----------------------|---------|--------------|------|
| Appraisal Year | 2019 | Assessment Year | 2019 | Knox County | 2.12 |
| Appraised Land | \$20,000 | Assessed Land | | | |
| Appraised Improvements | | Assessed Improvements | | | |
| Total Tax Appraisal | \$20,000 | Total Assessment | \$5,000 | | |
| | | Exempt Amount | | | |
| | | Exempt Reason | | | |

TAXES

| Tax Year | City Taxes | County Taxes | Total Taxes |
|----------|------------|--------------|-------------|
| 2019 | | \$106.00 | \$106.00 |
| 2018 | | \$106.00 | \$106.00 |
| 2017 | | \$106.00 | \$106.00 |
| 2016 | | \$145.00 | \$145.00 |
| 2015 | | \$145.00 | \$145.00 |
| 2014 | | \$145.00 | \$145.00 |
| 2013 | | \$145.00 | \$145.00 |

MORTGAGE HISTORY

No mortgages were found for this parcel.

PROPERTY CHARACTERISTICS: BUILDING

No Buildings were found for this parcel.

PROPERTY CHARACTERISTICS: EXTRA FEATURES

No extra features were found for this parcel.

PROPERTY CHARACTERISTICS: LOT

| | | | |
|---------------------------|------------------------|------------------------|----------------------|
| Land Use | Unused Land | Lot Dimensions | 61.38 X 229.55 X IRR |
| Block/Lot | /26 | Lot Square Feet | 17,599 |
| Latitude/Longitude | 36.069600°/-83.814062° | Acreage | |

PROPERTY CHARACTERISTICS: UTILITIES/AREA

| | | | |
|------------------------|-------|----------------------------------|--|
| Gas Source | Gas | Road Type | |
| Electric Source | | Topography | |
| Water Source | | District Trend | |
| Sewer Source | Sewer | Special School District 1 | |
| Zoning Code | | Special School District 2 | |
| Owner Type | | | |

LEGAL DESCRIPTION

| | | | |
|--------------------|--|-----------------------|----------------|
| Subdivision | Chestnut Ridge S/D Unit 1 | Plat Book/Page | 20020529/97929 |
| Block/Lot | /26 | District/Ward | COU |
| Description | Subdivisionname Chestnut Ridge S/D Unit 1 Mapplatb 20020529 Mapplatp 0097929 Dimensions 61.38 X 229.55 X Irr | | |

FEMA FLOOD ZONES

| Zone Code | Flood Risk | BFE | Description | FIRM Panel ID | FIRM Panel Eff. Date |
|-----------|------------|-----|--|---------------|----------------------|
| X | Minimal | | Area of minimal flood hazard, usually depicted on FIRMs as above the 500-year flood level. | 47093C0154F | 05/02/2007 |