

LOCATION

Property Address 3709 Eagles Vista Ln
Knoxville, TN 37924-1057
Subdivision Chestnut Ridge S/D Unit 1
County Knox County, TN

PROPERTY SUMMARY

Property Type Open Space
Land Use Unused Land
Improvement Type
Square Feet

GENERAL PARCEL INFORMATION

Parcel ID/Tax ID 041PA044
Alternate Parcel ID 176538
Account Number
District/Ward COU
2010 Census Trct/Blk 52.01/1
Assessor Roll Year 2018

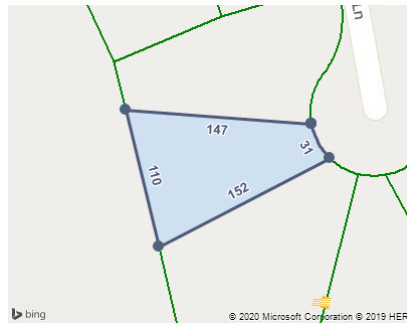

CURRENT OWNER

Name Regency Holdings LLC
Mailing Address 10255 Kingston Rd
Knoxville, TN 37922-3274

SALES HISTORY THROUGH 01/27/2020

Date	Amount	Buyer/Owners	Seller	Instrument	No. Parcels	Book/Page Or Document#
4/15/2005		Regency Holdings LLC	Bunch & Frazier Prop	Warranty Deed	46	200505100089859

TAX ASSESSMENT

Appraisal	Amount	Assessment	Amount	Jurisdiction	Rate
Appraisal Year	2019	Assessment Year	2019	Knox County	2.12
Appraised Land	\$20,000	Assessed Land			
Appraised Improvements		Assessed Improvements			
Total Tax Appraisal	\$20,000	Total Assessment	\$5,000		
		Exempt Amount			
		Exempt Reason			

TAXES

Tax Year	City Taxes	County Taxes	Total Taxes
2019		\$106.00	\$106.00
2018		\$106.00	\$106.00
2017		\$106.00	\$106.00
2016		\$145.00	\$145.00
2015		\$145.00	\$145.00
2014		\$145.00	\$145.00
2013		\$145.00	\$145.00

MORTGAGE HISTORY

No mortgages were found for this parcel.

PROPERTY CHARACTERISTICS: BUILDING

No Buildings were found for this parcel.

PROPERTY CHARACTERISTICS: EXTRA FEATURES

No extra features were found for this parcel.

PROPERTY CHARACTERISTICS: LOT

Land Use	Unused Land	Lot Dimensions	31.04 X 151.73 X IRR
Block/Lot	/70	Lot Square Feet	9,945
Latitude/Longitude	36.066850°/-83.818303°	Acreage	

PROPERTY CHARACTERISTICS: UTILITIES/AREA

Gas Source	Gas	Road Type	
Electric Source		Topography	
Water Source		District Trend	
Sewer Source	Sewer	Special School District 1	
Zoning Code		Special School District 2	
Owner Type			

LEGAL DESCRIPTION

Subdivision	Chestnut Ridge S/D Unit 1	Plat Book/Page	20020529/97929
Block/Lot	/70	District/Ward	COU
Description	Subdivisionname Chestnut Ridge S/D Unit 1 Mapplatb 20020529 Mapplatp 0097929 Dimensions 31.04 X 151.73 X Irr		

FEMA FLOOD ZONES

Zone Code	Flood Risk	BFE	Description	FIRM Panel ID	FIRM Panel Eff. Date
X	Minimal		Area of minimal flood hazard, usually depicted on FIRMs as above the 500-year flood level.	47093C0154F	05/02/2007