

LOCATION

Property Address Woods View Cir  
TN  
Subdivision Grandview Est Sec VII  
County Sevier County, TN

PROPERTY SUMMARY

Property Type Residential  
Land Use Household Units  
Improvement Type  
Square Feet

GENERAL PARCEL INFORMATION

Parcel ID/Tax ID 017E B 012.00  
Special Int 000  
Alternate Parcel ID  
Land Map 017E  
District/Ward 08  
2010 Census Trct/Blk 801.02/1  
Assessor Roll Year 2018

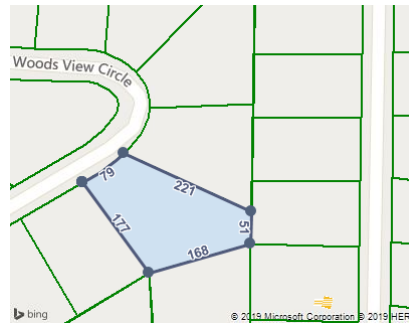

CURRENT OWNER

Name Sonnet Jacob W Scott J Sonnett Co-Trustees  
Mailing Address 826 Deaderick Rd  
Knoxville, TN 37920-8941

TAX ASSESSMENT

Appraisal	Amount	Assessment	Amount	Jurisdiction	Rate
Appraisal Year	2018	Assessment Year	2018		
Appraised Land	\$27,000	Assessed Land		Sevier	1.86
Appraised Improvements	\$7,000	Assessed Improvements			
Total Tax Appraisal	\$34,000	Total Assessment	\$8,500		
		Exempt Amount			
		Exempt Reason			

TAXES

Tax Year	City Taxes	County Taxes	Total Taxes
2018		\$158.10	\$158.10
2017		\$158.10	\$158.10
2016		\$158.10	\$158.10
2015		\$159.80	\$159.80
2014		\$127.14	\$127.14
2013		\$127.14	\$127.14

MORTGAGE HISTORY

No mortgages were found for this parcel.

PROPERTY CHARACTERISTICS: BUILDING

No Buildings were found for this parcel.

PROPERTY CHARACTERISTICS: EXTRA FEATURES

Feature	Size or Description	Year Built	Condition
Detached Garage Unfinished	14X30	1994	AVERAGE

PROPERTY CHARACTERISTICS: LOT

Land Use	Household Units	Lot Dimensions	81.03 X 223.57
Block/Lot	/12	Lot Square Feet	28,314
Latitude/Longitude	35.943732°/-83.589840°	Acreage	0.65

PROPERTY CHARACTERISTICS: UTILITIES/AREA

Gas Source		Road Type	Paved
Electric Source	Public	Topography	Rolling
Water Source	Private	District Trend	Improving
Sewer Source	Private	Special School District 1	
Zoning Code	R 1	Special School District 2	
Owner Type			

LEGAL DESCRIPTION

Subdivision	Grandview Est Sec VII	Plat Book/Page	27/5
Block/Lot	/12	District/Ward	08
Description	Revised		

FEMA FLOOD ZONES

Zone Code	Flood Risk	BFE	Description	FIRM Panel ID	FIRM Panel Eff. Date
X	Minimal		Area of minimal flood hazard, usually depicted on FIRMs as above the 500-year flood level.	47155C0105E	05/18/2009