



Friday, February 15, 2019

LOCATION

<b>Property Address</b>	11515 Packard Ln Knoxville, TN 37934-2728
<b>Subdivision</b>	Village Green Unit 7
<b>County</b>	Knox County, TN

PROPERTY SUMMARY

<b>Property Type</b>	Residential
<b>Land Use</b>	1 Family
<b>Improvement Type</b>	Single Family
<b>Square Feet</b>	2258

GENERAL PARCEL INFORMATION

<b>Parcel ID/Tax ID</b>	142FC013
<b>Alternate Parcel ID</b>	69706
<b>Account Number</b>	
<b>District/Ward</b>	FAR
<b>2010 Census Trct/Blk</b>	58.09/2
<b>Assessor Roll Year</b>	2017

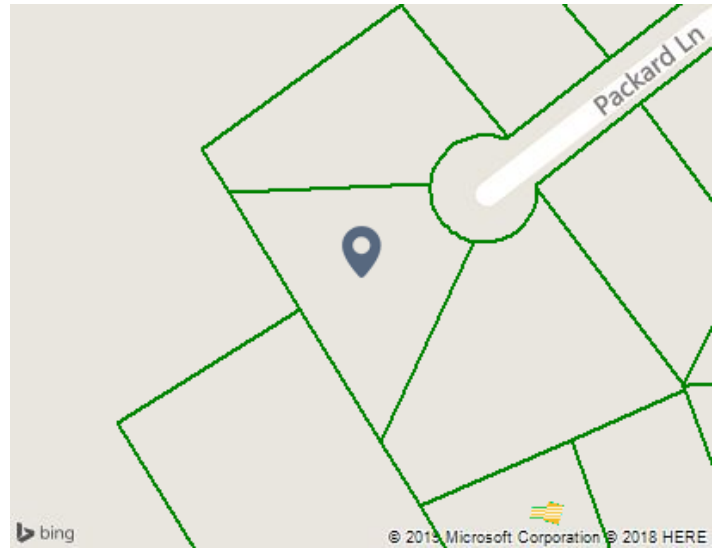

CURRENT OWNER

<b>Name</b>	German Glenn E Jacqueline W
<b>Mailing Address</b>	11515 Packard Ln Knoxville, TN 37934-2728

SALES HISTORY THROUGH 02/08/2019

Date	Amount	Buyer/Owners	Buyer/Owners 2	Instrument	No. Parcels	Book/Page Or Document#
11/9/1977	\$84,000	German Glenn E & Jacqueline W		Warranty Deed		1628/696
11/1/1977	\$84,000					

TAX ASSESSMENT

Appraisal	Amount	Assessment	Amount	Jurisdiction	Rate
<b>Appraisal Year</b>	2018	<b>Assessment Year</b>	2018		
<b>Appraised Land</b>	\$45,000	<b>Assessed Land</b>		<b>Knox County</b>	2.32
<b>Appraised Improvements</b>	\$235,000	<b>Assessed Improvements</b>			
<b>Total Tax Appraisal</b>	\$280,000	<b>Total Assessment</b>	\$70,000		
		<b>Exempt Amount</b>			
		<b>Exempt Reason</b>			

TAXES

Tax Year	City Taxes	County Taxes	Total Taxes
2018		\$1,484.00	\$1,484.00
2017		\$1,484.00	\$1,484.00
2016		\$1,565.00	\$1,565.00
2015		\$1,565.00	\$1,565.00
2014		\$1,564.84	\$1,564.84
2013		\$1,564.84	\$1,564.84

## MORTGAGE HISTORY

Date	Loan Amount	Borrower	Lender	Book/Page or Document#
04/16/1999	\$52,000	German Glenn E German Jacqueline W	Knoxville Tva Employees Credit Union	3574/0558

## PROPERTY CHARACTERISTICS: BUILDING

## Building # 1

Type	Single Family	Condition	Very Good For Age	Units	
Year Built	1973	Effective Year	1985	Stories	1
BRs	3	Baths	3 F 2 H	Rooms	9

Total Sq. Ft. 2,258

## Building Square Feet (Living Space)

1.0 Floor Level Finished 2258

## Building Square Feet (Other)

Basement Finished 1200

First Story (Base) 2258

Masonry Stoop 84

Masonry Stoop 112

Attached Garage 576

Open Frame Porch 18

Open Frame Porch 240

## - CONSTRUCTION

Quality	Good	Roof Framing	Gable
Shape		Roof Cover Deck	Asphalt Shingles
Partitions		Cabinet Millwork	
Common Wall		Floor Finish	
Foundation	1/2 Basement	Interior Finish	Drywall
Floor System		Air Conditioning	Central Ac
Exterior Wall	Masonry/Vinyl Siding	Heat Type	Central Warm Air
Structural Framing		Bathroom Tile	
Fireplace	Y	Plumbing Fixtures	17

## - OTHER

Occupancy

Building Data Source

## PROPERTY CHARACTERISTICS: EXTRA FEATURES

No extra features were found for this parcel.

## PROPERTY CHARACTERISTICS: LOT

Land Use	1 Family	Lot Dimensions	70M X 195.69 X IRR
Block/Lot	O/9	Lot Square Feet	27,289
Latitude/Longitude	35.885041°/-84.173132°	Acreage	

## PROPERTY CHARACTERISTICS: UTILITIES/AREA

Gas Source	Gas	Road Type	
Electric Source		Topography	
Water Source	Water	District Trend	
Sewer Source	Sewer	Special School District 1	
Zoning Code		Special School District 2	
Owner Type			

LEGAL DESCRIPTION

<b>Subdivision</b>	Village Green Unit 7	<b>Plat Book/Page</b>	54S/37
<b>Block/Lot</b>	O/9	<b>District/Ward</b>	FAR
<b>Description</b>	Subdivisionname Village Green Unit 7 Mapplatb 54S Mapplatp 37 Dimensions 70M X 195.69 X Irr		

FLOOD ZONE INFORMATION

Zone Code	Flood Risk	BFE	Description	FIRM Panel ID	FIRM Panel Eff. Date
X	Minimal		Area of minimal flood hazard, usually depicted on FIRMs as above the 500-year flood level.	47093C0243G	08/05/2013