

LOCATION

Property Address 152 Blackburn Dr
Bristol, TN 37620-3215
Subdivision Blackburn Sub
County Sullivan County, TN

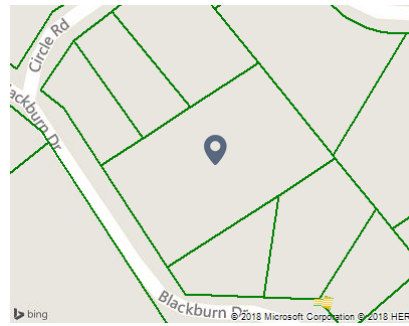

PROPERTY SUMMARY

Property Type Residential
Land Use Residential
Improvement Type Single Family
Square Feet 1696

GENERAL PARCEL INFORMATION

Parcel ID/Tax ID 019N B 006.00
Special Int 000
Alternate Parcel ID
Land Map 019N
District/Ward 05
2010 Census Trct/Bik 425/2
Assessor Roll Year 2017

CURRENT OWNER

Name Spurlock Angela
Mailing Address 152 Blackburn Dr
Bristol, TN 37620-3215

SALES HISTORY THROUGH 12/06/2018

Date	Amount	Buyer/Owners	Buyer/Owners 2	Instrument	No. Parcels	Book/Page Or Document#
7/25/2014		Spurlock Angela				3127/2031
4/19/1962		Spurlock Ernest W & Gladys Lee Nuckolls				220A/374
7/12/1954						154A/220

TAX ASSESSMENT

Appraisal	Amount	Assessment	Amount	Jurisdiction	Rate
Appraisal Year	2017	Assessment Year	2017		
Appraised Land	\$31,100	Assessed Land		Sullivan	2.55
Appraised Improvements	\$99,700	Assessed Improvements			
Total Tax Appraisal	\$130,800	Total Assessment	\$32,700		
		Exempt Amount			
		Exempt Reason			

TAXES

Tax Year	City Taxes	County Taxes	Total Taxes
2017		\$833.85	\$833.85
2016		\$762.32	\$762.32
2014		\$682.40	\$682.40
2013		\$682.40	\$682.40

MORTGAGE HISTORY

Date	Loan Amount	Borrower	Lender	Book/Page or Document#	Assignments/ Releases
07/21/2016	\$20,819	Spurlock Angela J	First Franklin	3208/715 16012096	
04/13/2016	\$1,435	Spurlock Angela	Bristol Tennessee Essential Services	3197/1218 16006531	
10/29/2015	\$7,200	Spurlock Angela	Bristol Tennessee Essential Services	3180/1454 15020323	
08/12/2014	\$7,475	Spurlock Angela	Bristol Tennessee Essential Services	3131/143 14014428	R

ASSIGNMENTS & RELEASES

Mortgage Date	New Lender	Original Lender	Borrower	Book/Page or Document#	Recorded Date	Document Type
08/12/2014		Bristol Tennessee Essential Svcs	Spurlock Angela	3158/465 15008059	5/18/2015	Release

PROPERTY CHARACTERISTICS: BUILDING

Building # 1						
Type	Single Family	Condition	Average	Units		
Year Built	1959	Effective Year	1982	Stories	1	
BRs		Baths	F H	Rooms		
Total Sq. Ft.	1,696	Building Square Feet (Other)				
Building Square Feet (Living Space)	Base 1696	Garage Finished 576 Open Porch Finished 216				

- CONSTRUCTION

Quality	Average	Roof Framing	Gable/Hip
Shape	U-Shaped	Roof Cover Deck	Composition Shingle
Partitions		Cabinet Millwork	Below Average
Common Wall		Floor Finish	Carpet Combination
Foundation	Continuous Footing	Interior Finish	Paneling Below Average
Floor System	Wood W/ Sub Floor	Air Conditioning	
Exterior Wall	Common Brick	Heat Type	Radiant Heat
Structural Framing		Bathroom Tile	
Fireplace	Y	Plumbing Fixtures	3
- OTHER		Building Data Source	Inspection
Occupancy	Occupied		

PROPERTY CHARACTERISTICS: EXTRA FEATURES

Feature	Size or Description	Year Built	Condition
Stoop	4X7	1959	GOOD

PROPERTY CHARACTERISTICS: LOT

Land Use	Block/Lot	Lot Dimensions	Lot Square Feet
Residential	1/6&7	190 X 329 IRR	

Latitude/Longitude	36.576698°/-82.245820°	Acreage
--------------------	------------------------	---------

PROPERTY CHARACTERISTICS: UTILITIES/AREA

Gas Source	Public - Natural Gas	Road Type	Paved
Electric Source	Public	Topography	Rolling
Water Source	Public	District Trend	Improving
Sewer Source	Individual	Special School District 1	
Zoning Code	R 1	Special School District 2	
Owner Type			

LEGAL DESCRIPTION

Subdivision	Blackburn Sub	Plat Book/Page	4/132
Block/Lot	1/6&7	District/Ward	05
Description			

FLOOD ZONE INFORMATION

Zone Code	Flood Risk	BFE	Description	FIRM Panel ID	FIRM Panel Eff. Date
X	Minimal		Area of minimal flood hazard, usually depicted on FIRMs as above the 500-year flood level.	47163C0103D	09/29/2006
X	Minimal		Area of minimal flood hazard, usually depicted on FIRMs as above the 500-year flood level.	47163C0103D	09/29/2006